

Note: These fixings are suitable for solid walls only. Plasterboard or stud walls may require specialist fixings (not supplied). **Caution:** Care should be taken when drilling walls and floors to avoid any sunken wires or pipes.

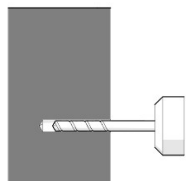

1. Drill two holes in the required position on the wall using a 14mm masonry drill bit, to a depth of 75mm. See page 2 for hole position detail.

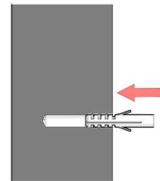

2. Push a wall plug into each hole.

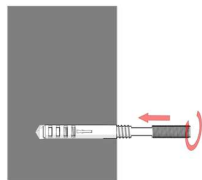

3. Screw the hanger bolt into each wall plug using a 8mm spanner until the spanner contacts the wall.

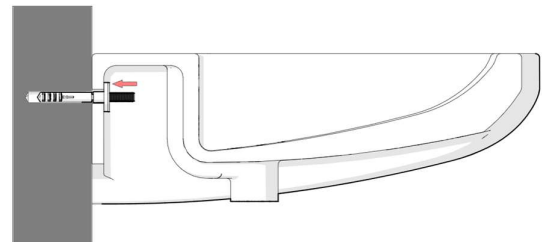

4. Place the basin in position against the wall locating the hanger bolts through the holes in the rear of the basin. Push a plastic washer, followed by a metal washer, onto each hanger bolt.

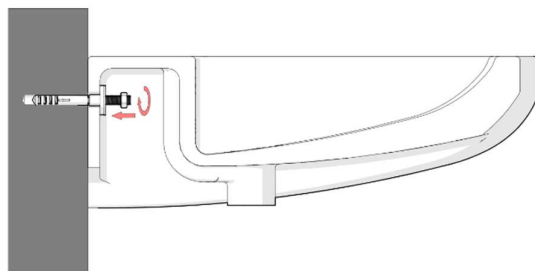

5. Screw a metal nut onto each hanger bolt to secure the basin. **Caution:** Do not overtighten as this may damage the ceramic.

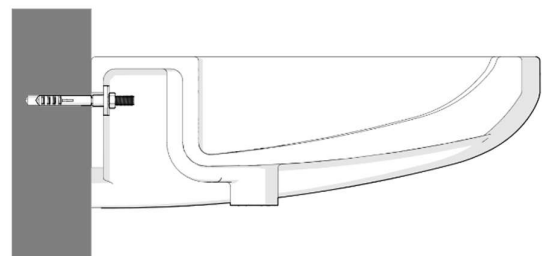

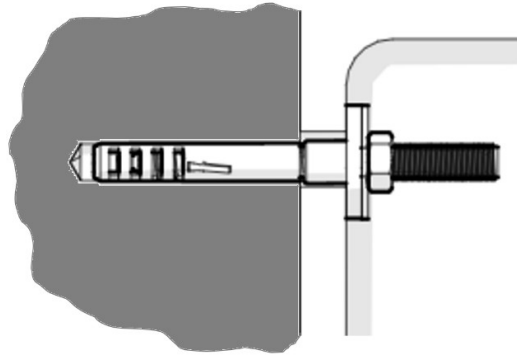

Figure 2. Detail view of fixings

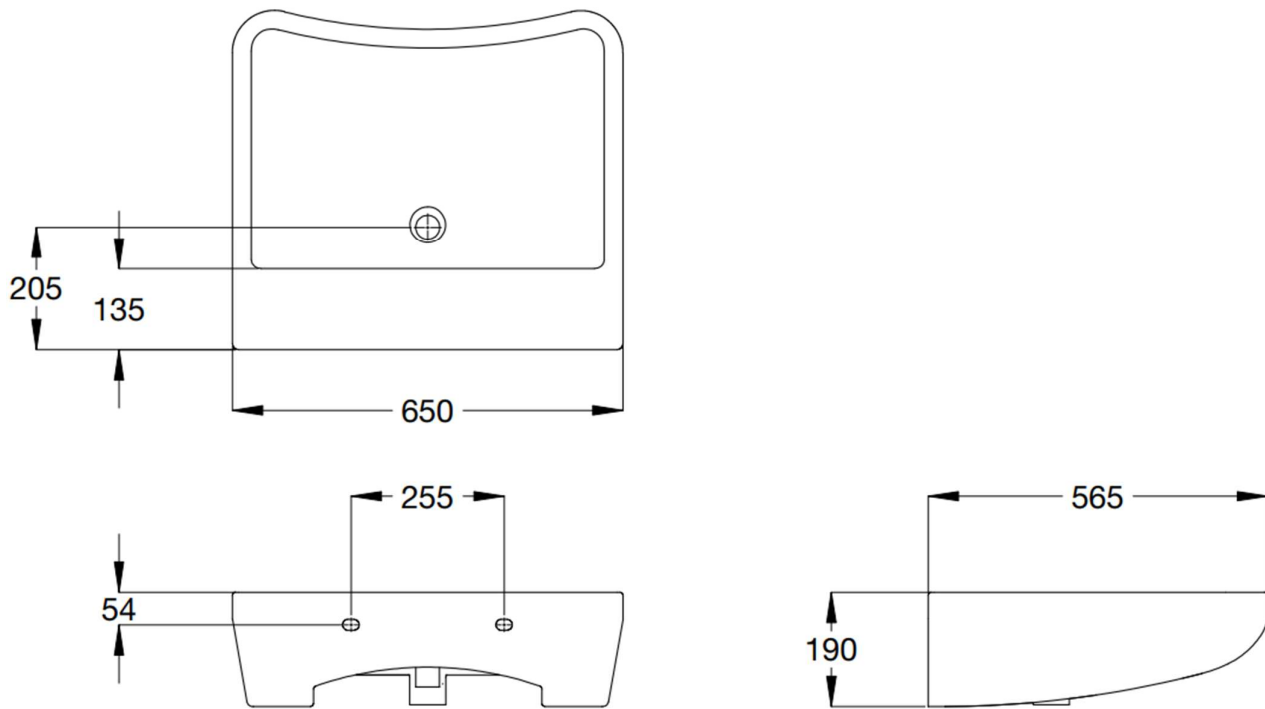

Figure 3. Basin dimensions